

NFPA LIFE SAFETY DATA	FLORIDA BUILDING CODE DATA
FLORIDA FIRE PREVENTION CODE, SEVENTH EDITION INCLUDING NFPA, 1 FIRE CODE AND NFPA 101, LIFE SAFTEY CODE, 2018 EDITION	FLORIDA BUILDING CODE 2020- SEVENTH EDITION
NEW AIRCRAFT HANGAR STORAGE OCCUPANCY CHAPTER 42 ORDINARY HAZARD BUILDING IS NOT FULLY SPRINKLERED	USE AND OCCUPANCY S-1 AIRCRAFT STORAGE HANGAR CHAPTER 3
NFPA 42.6 SPECIAL PROVISIONS FOR AIRCRAFT HANGARS	SPECIAL DETAILED REQUIREMENTS BASED ON USE & OCCUPANCY CHAPTER 4- 412- AIRCRAFT RELATED SPECIAL REQUIREMENTS
2 MEANS OF EGRESS REQUIRED FROM ALL AIRCRAFT HNAGAR AREAS.	[F] 412.4.6.1 HAZARDOUS OPERATIONS. ANY GROUP III AIRCRAFT HANGAR ACCORDING TO TABLE 412.4.6 THAT CONTAINS HAZARDOUS OPERATIONS INCLUDING, BUT NOT LIMITED TO, THE FOLLOWING SHALL BE PROVIDED WITH A GROUP I OR II FIRE SUPPRESSION SYSTEM IN ACCORDANCE WITH NFPA 409 AS APPLICABLE.
EXITS FROM AIRCRAFT STORAGE AREASSHALL BE AT INTERVALS NOT EXCEEDING 150 FT.	1. DOPING.
HORIZAONTAL EXITS AT FIRE BARRIERS SHALL NOT EXCEED 100 FT. SPACING.	2. HOT WORK INCLUDING, BUT NOT LIMITED TO, WELDING, TORCH CUTTING AND TORCH SOLDERING
"SMASH DOORS" NOT APPLICABLE	3. FUEL TRANSFER.
MEZZANINES NOT APPLICABLE.	4. FUEL TANK REPAIR OR MAINTENANCE NOT INCLUDING DEFUELED TANKS IN ACCORDANCE WITH NFPA 409, INERTED TANKS OR TANKS THAT HAVE NEVER BEEN FUELED.
DEAD ENDS SHALL NOT EXCEED 50 FT. FOR NON HIGH HAZARD AREAS.	5. SPRAY FINISHING OPERATIONS.
MAXMUM COMMON PATH OF TRAVEL- ORDINARY HAZARD, UN-SPRINKLERED = 50 FT	6. TOTAL FUEL CAPACITY OF ALL AIRCRAFT WITHIN THE UNSPRINKLERED SINGLE AREA IN EXCESS OF 1,500 GALLONS (687 L).
DEAD END 50 FT. MAX.	7.TOTAL FUEL CAPACITY OF ALL AIRCRAFT WITHIN THE MAXIMUM SINGLE FIRE AREA IN EXCESS OF 7,500 GALLONS (28 390 L) FOR A HANGAR WITH AN AUTOMATIC SPRINKLER SYSTEM IN ACCORDANCE WITH SECTION 903.3.1.1.
MAXIMUM TRAVEL DISTANCE TO EXITS ORDINARY HAZARD, UNSPRINKLERED=200 FT MAX	GENERAL BUILDING HEIGHTS AND AREAS CHAPTER 5- ALLOWABLE HEIGHT TYPE IIIB N.S. 55 FT.
UNPROTECTED VERTICAL OPENINGS NOT APPLICABLE	STORIES ABOVE GRADE PLANE S-1, N.S. = 3 MAX
INTERIOR WALL AND CEILING FINISHES-PER REQUIREMENTS	BUILDING AREA, S-1, N.S. = 17,500
DETECTION ALARM & COMMUNICATION NOT REQUIRED	AREA MOD. FOR BUILDING C NOT REQUIRED
NFPA 409 STANDARD ON AIRCRAFT HANGERS	TYPE CONSTRUCTION: IIIB
GROUP III HANGAR TYPE III(200) CONSTRUCTION TYPE PER NFPA 220	CH 6 FIRE RATED EXTERIOR WALLS S-1 OCC , X IS GREATER THAN
HANGAR DOORS LESS THAN 28 FT. HIGH	OR EQUAL TO 30 FT ALLOW ZERO HOUR RATED EXT WALLS.
MAXIMUM FIRE AREA LESS THAN 12,000 S.F.	
BUILDING UNSPRINKLERED AS ALLOWED AS ORDINARY HAZARD PER FBC 412.4.6.1	

EMERGENCY RADIO SIGNAL / BI-DIRECTIONAL AMPLIFICATION

ALL BUILDINGS SHALL BE TESTED FOR EMERGENCY RADIO SIGNAL STRENGTH AFTER THE SHELL IS CONSTRUCTED. VERIFY WITH MUNICIPALITY FIRE DEPARTMENT FOR TESTING REQUIREMENTS PRIOR TO TESTING. IF THE BUILDING IS FOUND TO REQUIRE A B.D.A. (BI-DIRECTIONAL AMPLIFICATION SYSTEM) OWNER WILL ENGAGE A SPECIALTY ENGINEER TO DESIGN A BOOSTER SYTEM IN FULL ACCORDANCE WITH NFPA 72 AND LOCAL AUTHORITIES HAVING JURISDICTION.

DETAILS OF CONSTRUCTION SUCH AS LOCATION OF HEAD END
EQUIPMENT AND CABLE
PATHWAYS VERTICALLY AND HORIZONTALLY SHALL BE SPECIFIED.

THE CONSTRUCTION DRAWINGS WILL INCLUDE PLANNING FOR POSSIBLE BDA EQUIPMENT LOCATION AND CONDUITS. BDA WILL BE IN A TWO HOUR FIRE RATED ROOM NOT LESS THAN 3'WIDE BY 5' LONG. VERTICAL CABLE CHASES IF NECESSARY WILL NEED TO PROVIDE 2 HOUR FIRE RATING. HORIZONTAL CABLE NEED NOT BE FIRE RATED. CABLE AND EQUIPMENT SHALL NOT BE LOCATED IN STAIRS

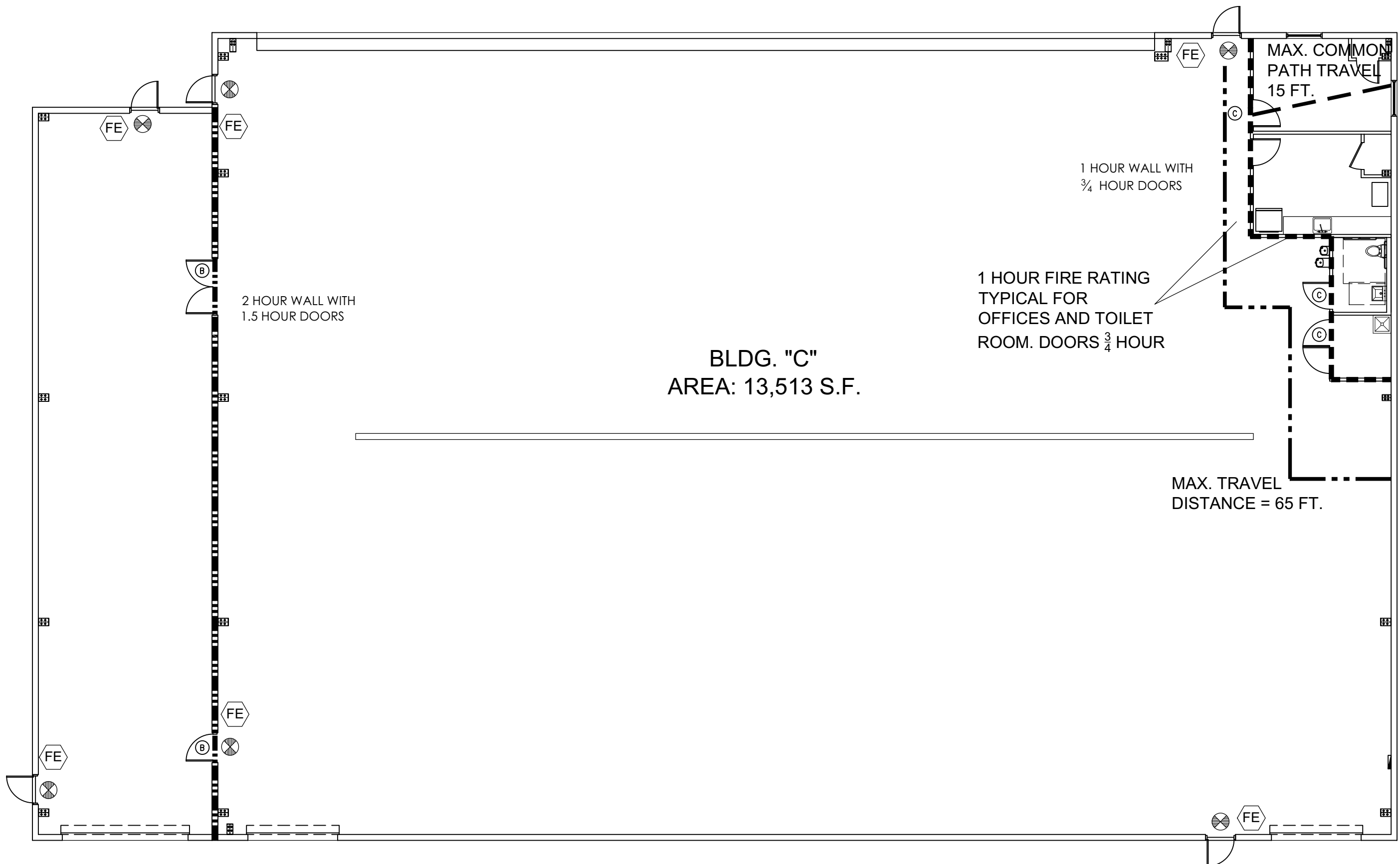

A4 BUILDING C LIFE SAFETY PLAN
3/32" = 1'-0"

GENERAL NOTES:

UN-SPRINKLERED

LEGEND

----- TRAVEL DISTANCE PATH

- - - - - COMMON PATH

⊥ DEAD-END CORRIDOR

⊥ CLG. MTD. DIRECTIONAL EXIT SIGN

⊥ WALL MTD. EXIT SIGN

⊥ FIRE EXTINGUISHER - SEMI-RECESSED CABINET W/ 3A 4BC RATING

⊥ FIRE EXTINGUISHER - WALL MOUNTED W/BRACKET W/ 3A 4BC RATING

⊥ F.D. KEY BOX LOCATION (VERIFY W/ F.D. MANUFG. TYPE KNXK OR SUPRA)

⊥ EMERGENCY LIGHT

EGRESS DATA, FBC S-1 OCC

OCCUPANCY LOAD

S-1

MAX. TRAVEL DISTANCE TO EXIT (FT)

200'

MAX. DEAD END CORRIDOR

20'

MIN. CORRIDOR WIDTH

44"

MIN. CLEAR OPENING

32"

MAX. COMMON PATH (FT)

50'

OCCUPANCY LOAD SUMMARY FBC CH 10

OCCUPANCY CLASSIFICATION: GROUP S-1

CAPACITY PER F.B.C 1004.5 AIRCRAFT HANGARS 1 PER 500 GROSS

EACH HANGAR IS 5600 SF THEREFORE OCCUPANT LOAD IS 5600/500=11.2 THEREFORE 13 PEOPLE EACH BAY.

INTERIOR FINISH CLASSIFICATION LIMITATIONS

OCCUPANCY S-1 UN-SPRINKLERED

CEILING	EXIT	CORRIDORS	OTHER SPACES
A	B	B	C

CLASS I - FLAME, SMOKE, AND SOUND (F.S.S.) (RED)

CLASS II - FLAME, SMOKE, AND SOUND (F.S.S.) (RED)

CLASS I OR II ARE PERMITTED

CLASS I - GASES, RADIANT HEAT, NOT LESS THAN 45°C (yellow)

CLASS II - GASES, RADIANT HEAT, NOT LESS THAN 45°C (yellow)

CLASS III - GASES, RADIANT HEAT, NOT LESS THAN 45°C (yellow)

CLASS III - GASES, RADIANT HEAT, NOT LESS THAN 45°C (yellow)

PARTITION DATA

UN-SPRINKLERED

LEGEND

⊥ NOT USED

⊥ 90 MIN FIRE LABEL DOOR

⊥ 45 MIN FIRE LABEL DOOR

⊥ 30 MIN FIRE LABEL DOOR

GHA
GALLO HERBERT ARCHITECTS
1311 W NEWPORT CENTER DRIVE DEERBEACH, FLORIDA 33442 PH
F X . 9 5 4 . 7 9 4 . 0 3 0 0
9 5 4 . 7 9 4 . 0 3 0 0

AA226001731

SEAL

☐ WILLIAM J. GALLO FL AR0008440

Brian Herbert Digitally signed by **Brian Herbert**
Date: 2022.06.30 14:34:52 -04'00'

☐ BRIAN P. HERBERT FL AR0015474

PROJECT

POMPANO
C BEACH AIR
PARK PARCEL Y

601 NE 10TH ST.
POMPANO BEACH
FL 33060

POMPANO BEACH

[illegible]

10/19/2022

PZ22-12000020
9/21/2022

PZ22-12000020
8/3/2022